

Gyro Unit-for MINI-Z RACER MR-03

Thank you for purchasing the G-Force Gyro Unit. Please read these instructions carefully and thoroughly before installation this unit to your Mini-Z MR-03.

This Gyro Unit plugs right into the main board of your MR-03 and will help you keep your MR-03 under control. The Gyro Unit will automatic correct of steering and throttle. Basically it will keep the steering aimed to the global direction, so say your rear tires loose traction and the chassis come to an angle, this will counter steer for you faster than humanely possible. Very cool, and really impressive having the car stable like if it was following a rail on low traction surfaces (wood, tiles).

1

Detach parts as shown in diagram.

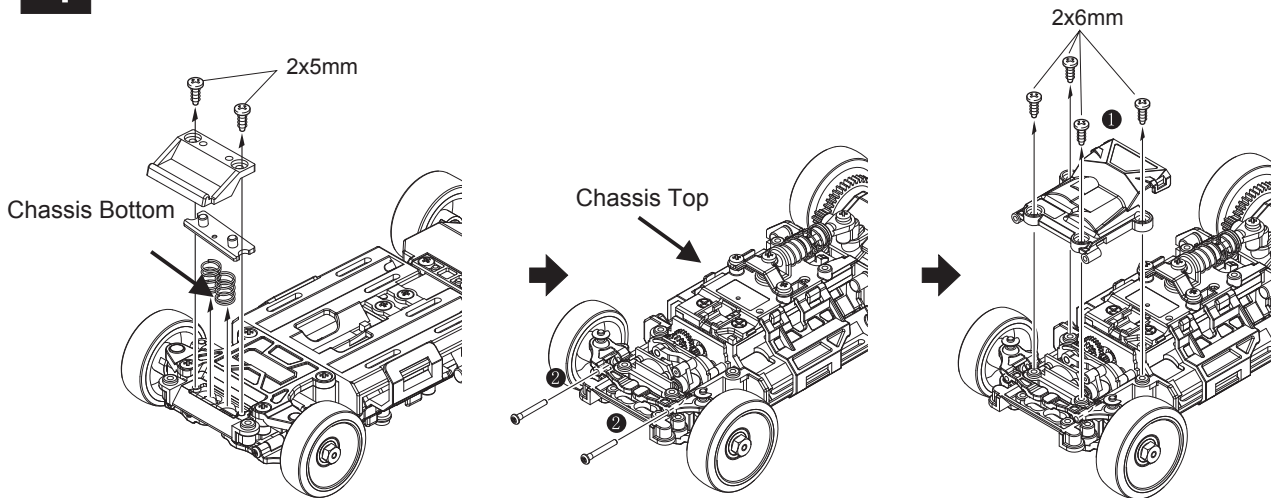

2

Attach gyro unit as shown in diagram.

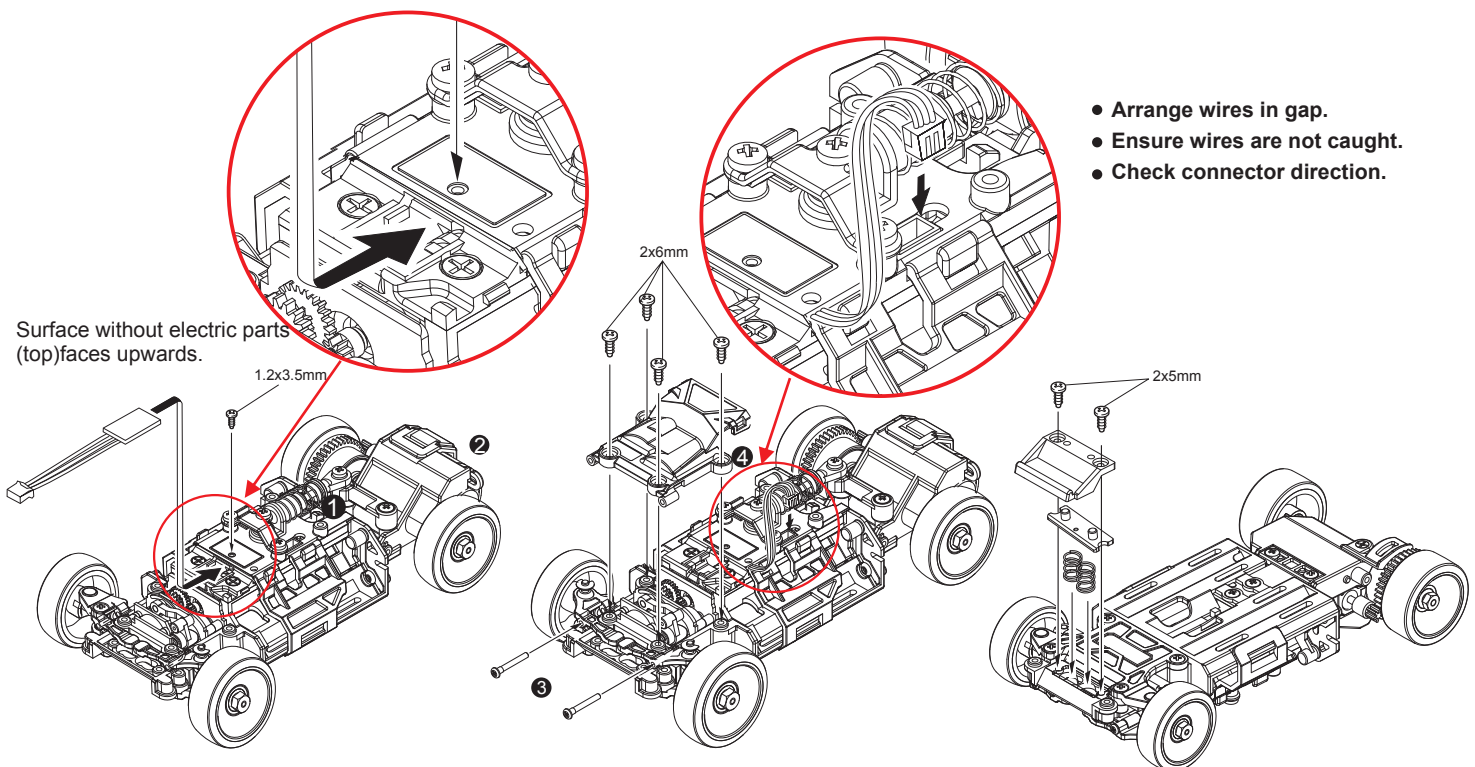

Products by
G-FORCE, Inc.
www.gforce-hobby.jp

Mare-kanda Bld.9F, 1-3-1, Kajicho, Chiyoda-ku,
Tokyo, 101-0044, JAPAN



Made in China Ver.1.0